

DISTRICT

REAL ESTATE ADVISORS

303

SUMNER STREET  
EAST BOSTON

FOR SALE  
OR  
LEASE





## PROPERTY & MARKET HIGHLIGHTS



1,500 SF at Street Level  
& 1,500 SF Basement

600 SF Outdoor Patio  
(22 x 28)



Delivery: Immediately



Restaurant / Café



Maverick Station:  
10,000 Daily Blue Line  
Riders



40,000 Residents



Tenancy: Craft Table &  
Bar, Santarpio's Pizza,  
Rino's Place, The  
Reelhouse, Piers Park  
Sailing Center,  
Downeast Cider House



# FLOORPLAN

1,500 SF at Street Level & 1,500 SF Basement

600 SF Outdoor Patio (22 x 28)

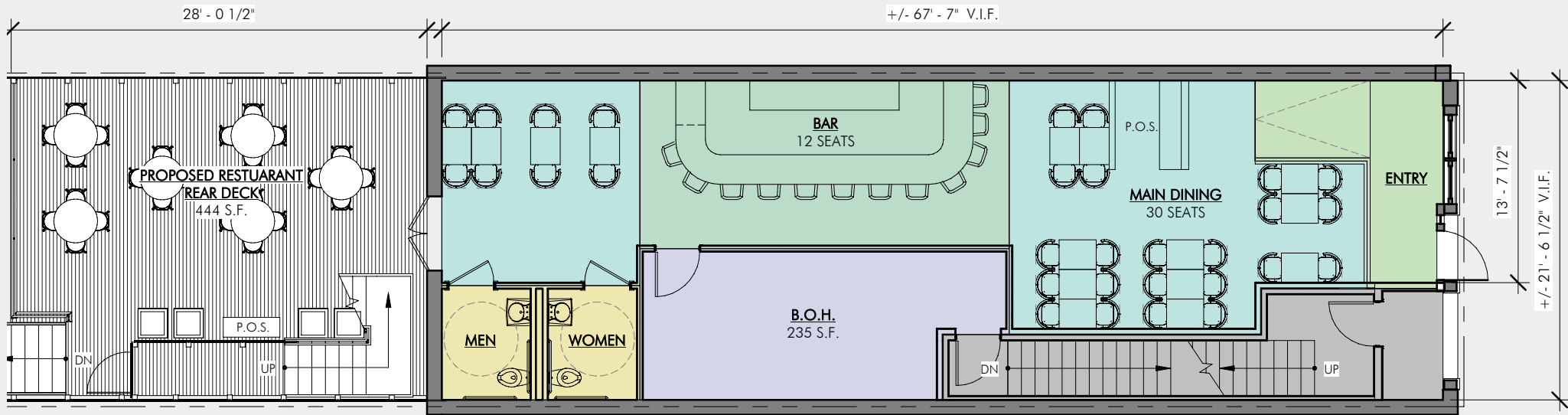



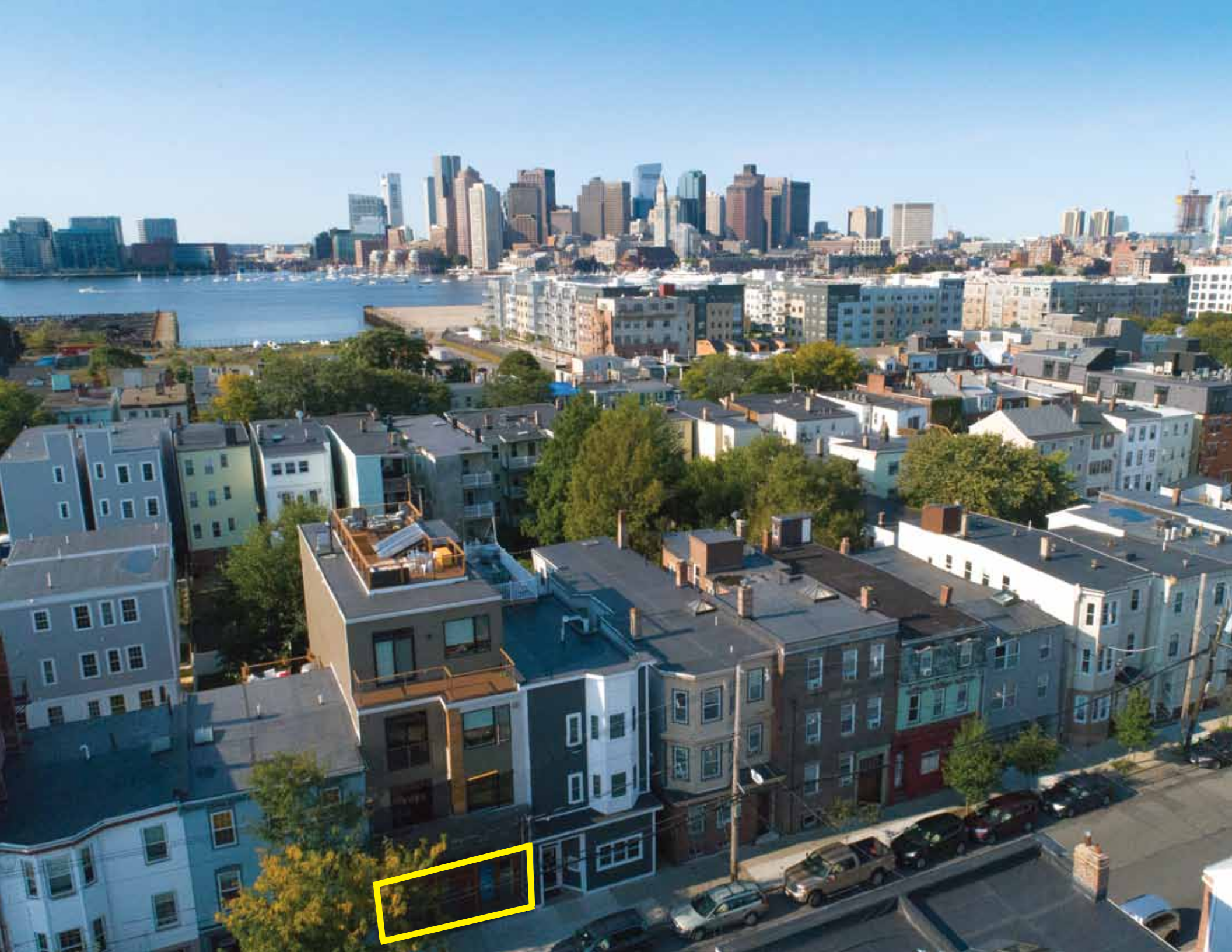



REAL ESTATE ADVISORS

## CONTACT:

CHRISTOPHER MEARN  
617-595-1544  
cmearn@districtadvisors.com

RICH LOBKOWICZ  
561-251-7864  
rlobkowicz@districtadvisors.com



867 Boylston Street, 5th Floor | Boston, MA 02116 | T: (857) 284 7971 | [www.districtadvisors.com](http://www.districtadvisors.com)

---

*This Information has been secured from sources we believe to be reliable, but we make no representations or warranties, expressed or implied, as to the accuracy of the information. References to renderings, square footage, demographics, traffic count or age are approximate. All Parties must verify the information and bears all risk for any inaccuracies.*